

**PLAN**

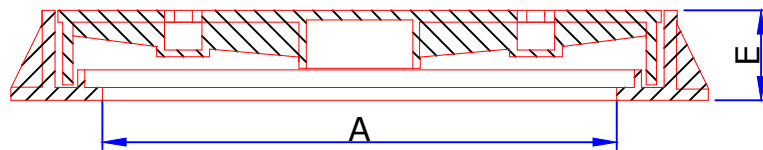

**SECTIONAL VIEW OF COVER & FRAME**

CODE	CLEAR OPENING A (mm)	OVER BASE BXC (mm)	DEPTH E (mm)	LOADING kN	STANDARD
DI-19	Ø600	750x750	75	125	EN 124-2015

DATE : 07-03-2018	<u>DESCRIPTION :</u> 600 MM DIA CLEAR OPENING CIRCULAR SOLID TOP DUCTILE IRON LOADING CLASS B-125 COVER & FRAME	REV : 01
DRAWN BY : GK		SCALE : NTS
CHECKED BY: PC		ALL DIMENSIONS ARE
APP.BY: AB		IN MM