

PLAN

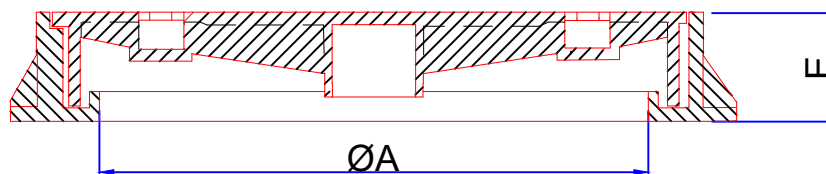

SECTIONAL VIEW

CODE	CLEAR OPENING A (mm)	OVER BASE BXC (mm)	DEPTH E (mm)	LOADING kN	STANDARD
DI-18	Ø600	760X760	100	400	EN 124-2015 .

DATE : 24-10-18	DESCRIPTION : 600MM DIA CLEAR OPENING DUCTILE IRON LOADING CLASS D-400 CIRCULAR COVER & FRAME	REV : 0
DRAWN BY : GK		SCALE : NTS
CHECKED BY: KM		ALL DIMENSIONS ARE
APP. BY: AB		IN MM