

PLAN OF COVER & FRAME

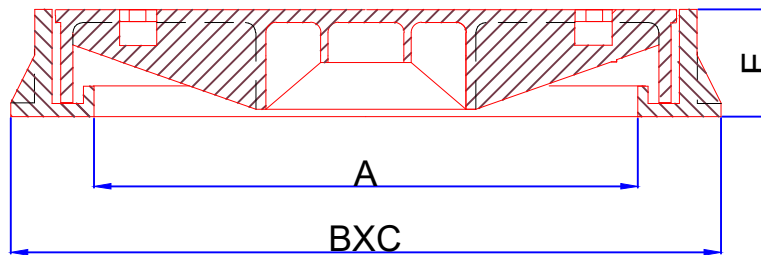

SECTIONAL VIEW

CODE	CLEAR OPENING A (mm)	OVER BASE BXC (mm)	DEPTH E (mm)	LOADING KN	STANDARD
DI-17	Ø675	805X805	102	400	EN 124-2015

DATE : 24-10-18	<u>DESCRIPTION :</u> 675 MM DIA CLEAR OPENING DUCTILE IRON LOADING CLASS D-400 CIRCULAR SOLID TOP COVER & FRAME	REV : 0
DRAWN BY : GK		SCALE : NTS
CHECKED BY : KM		ALL DIMENSIONS ARE
APP.BY: AB		IN MM